



## Motor-Generator Drive Flexible Tyre Couplings Technical Specifications



### Rubber Coupling Technical Specification TYRE HIC Manufactured UNIVERAL Brand

Universal Tyre Couplings ensures **high torque transmitting capacity** in motor generators, etc in various industrial machines, in a way, the true **tyre material** is made from neoprene/ natural/synthetic rubber compounds reinforced with Rayon/ Nylon/ Polyester Cord to give superior rating & long durability, **bore size** is well matched to attain maximum speed (rpm) ensuring minimum to **nil slippage** of the **flexible** element out from the coupling assembly in case of any faulty installation.

### Rubber Coupling FLEXIBLE SHAFT Drive Product Specification

- TC-series Conventional rubber tyre unique interchangeable motor couplings 006 to 024 sizes upto 530 mm Outer Diameter 170 mm maximum bore and spare tyre.
- F series Multidirectional flexible rathi interchangeable tyre couplings 40 to 200 sizes upto 190 mm max bore and spare tyre.
- PH series New Generation flexible fenaflex interchangeable shaft couplings 96 to 450 sizes upto 175 mm max bore and spare tyre. Ease of use as no lubrication needed, absorbs big misalignment thus saves downtime.
- HRC-series fenner interchangeable flexible shaft cushion couplings 090 to 280 sizes upto 115mm max bore and spare element.



Tyre Coupling

**Bore sizes :** 6mm to 280mm  
**Speed (rev./min.) :** From 500 to 7000 rpm.

#### Contact For Quote:

HIC INTERNATIONAL CO -Motors Drive Tyre Coupling Div

D-136, Shankar Road, New Delhi - 110060, India

**Phone:** 91-11-6547 2400, 2874 5120

**Fax:** 91-11-2874 2791

**E-mail :** universal@hic-india.com; belts@universaldelhi.org

**Website :** <http://www.rubber-steel-industrial-products.com>

**Key personnel :** Mr. Anil Gupta, President



## Motor-Generator Drive Flexible Tyre Couplings Technical Specifications



### Motor Coupling Dimension Details TC - series

Coupling tyre size	Tyre coupling max. bore mm	Max speed RPM	Count rating	Couplings approx. dimension (mm)				
			HP/100 RPM	Coupling tyre O.D. (A)	Coupling length (L)	Hub dia (D)	Flange length (E)	Gap bet. two flanges (M)
001-TC/Z	9	6000	Nominal	42	54	27	19	16
002-TC/Z	11	6000	Nominal	54	68	38	24	20
003-TC/Z	14	6000	Nominal	70	78	43	27	24
004-TC/Z	18	5500	Nominal	93	74	30	26	22
005-TC/Y	20	6500	0.07	97	74	35	25	24
006-TC/X	22	5500	0.14	105	84	38	32	20
007-TC/W	24	5500	0.21	105	111	43	40	31
008-TC/V	28	5500	0.28	120	95	51	37	21
009-TC/U	32	5500	0.42	135	108	58	39	30
009-TC/US	38	5500	0.55	144	120	66	48	24
010-TC/T	44	4400	0.63	160	132	71	49	34
011-TC/S	45	4300	0.77	164	133	75	51	31
012-TC/R	44	4200	0.98	176	147	71	53	41
013-TC/Q	50	3750	1.54	188	145	80	53	39
014-TC/P	55	3200	2.1	212	155	95	56	43
015-TC/O	70	2750	3.1	240	173	118	62	49
016-TC/N	85	2700	4.2	270	181	140	80	45
017-TC/M	90	2600	6.6	280	215	145	76	63
018-TC/L	95	2550	8.4	310	195	154	90	15
019-TC/K	100	2450	11.0	316	202	159	95	10
020-TC/J	125	2200	16.8	370	225	203	110	6
021-TC/I	125	2000	21.0	370	240	203	115	10
022-TC/H	140	1700	33.6	412	256	237	118	20
023-TC/G	140	1600	52.0	448	280	230	125	30
024-TC/F	170	1300	75.2	530	282	315	128	26
025-TC/E	145	1250	98.1	546	365	260	147	71
026-TC/D	145	1080	117.1	630	457	387	203	51
027-TC/C	on enq	960	138	746				On enquiry
028-TC/B	on enq	960	173	746				On enquiry

#### Contact For Quote:

HIC INTERNATIONAL CO -Motors Drive Tyre Coupling Div

D-136, Shankar Road, New Delhi - 110060, India

**Phone:** 91-11-6547 2400, 2874 5120

**Fax:** 91-11-2874 2791

**E-mail :** universal@hic-india.com; belts@universaldelhi.org

**Website :** <http://www.rubber-steel-industrial-products.com>

**Key personnel :** Mr. Anil Gupta, President



## Motor-Generator Drive Flexible Tyre Couplings Technical Specifications



### Coupling Sectional View (TC-SERIES)

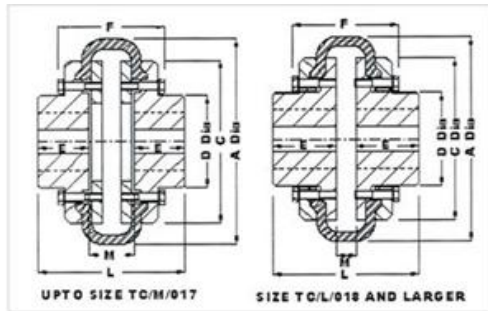

### TC Rubber Tyre Couplings

### Flexible Coupling Dimension Details F - series

Coupling flexible tyre size	Tyre coupling bore		A mm	L mm	D mm	E mm	C mm	G** mm	M** mm	F mm	Motor power per 100 rev./min kw.	Power per 100 rev./min H.P.	Max speed rev/min
	min mm	max. mm											
40-F	13	30	104	66	-	22	82	43	22	-	0.20	0.26	4400
45-F	13	32	120	74	-	25	94	43	24	-	0.35	0.46	4400
50-F	18	38	133	89	79	32	100	43	25	-	0.50	0.67	4400
60-F	18	48	165	109	73	38	125	43	33	-	1.05	1.40	3900
70-F	20	55	197	130	82	45	144	10	40	101	1.60	2.14	3600
80-F	26	65	211	145	95	51	167	10	43	106	2.55	3.41	3000
85-F	32	70	222	150	103	53	179	13	44	107	3.10	4.15	2900
90-F	32	76	235	160	110	57	188	13	46	119	3.75	5.02	2800
100-F	32	85	254	168	124	60	216	13	48	123	5.19	6.95	2500
110-F	32	90	279	174	134	65	233	14	44	127	7.32	9.80	2200
120-F	39	102	314	201	152	76	264	14	49	140	12.20	16.34	2000
140-F	76	120	359	211	195	89	311	14	24	152	19.20	25.72	1700
160-F	75	140	402	234	216	102	345	19	30	156	32.10	43.01	1500
180-F	75	175	470	274	266	114	398	19	46	188	57.00	76.38	1400



#### Contact For Quote:

HIC INTERNATIONAL CO -Motors Drive Tyre Coupling Div

D-136, Shankar Road, New Delhi - 110060, India

**Phone:** 91-11-6547 2400, 2874 5120

**Fax:** 91-11-2874 2791

**E-mail :** universal@hic-india.com; belts@universaldelhi.org

**Website :** <http://www.rubber-steel-industrial-products.com>

**Key personnel :** Mr. Anil Gupta, President



## Motor-Generator Drive Flexible Tyre Couplings Technical Specifications



**G\*** is the amount by which clamping screws need to be withdrawn to release tyre.

**M\*\*** is the distance between flanges.

Normally shaft ends may be kept M distance apart, however, they can be kept at larger distance apart. Care being taken that sufficient shaft keyway length is covered by the Hub. The shaft length can also be brought nearer each other keeping in mind the end-play between the shafts to avoid chattering.

### Coupling Sectional View (F-SERIES)

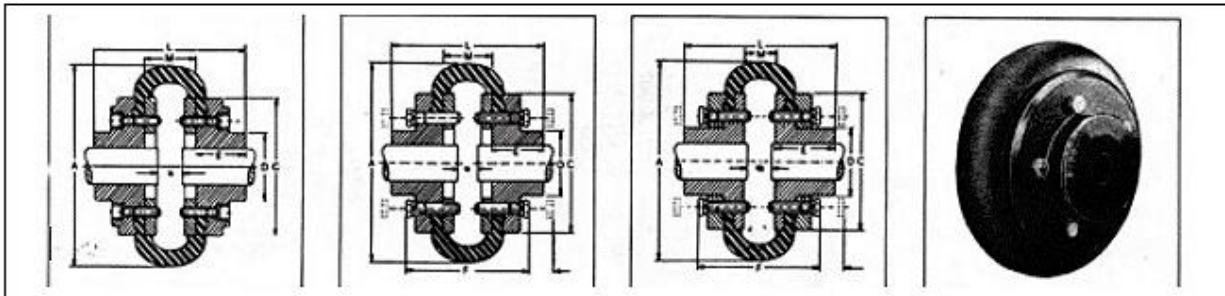

From Size 40 F to 60 F

From Size 70 F to 120 F

From Size 140 F & onwards

### F Tyre Couplings



#### Contact For Quote:

HIC INTERNATIONAL CO -Motors Drive Tyre Coupling Div

D-136, Shankar Road, New Delhi - 110060, India

**Phone:** 91-11-6547 2400, 2874 5120

**Fax:** 91-11-2874 2791

**E-mail :** universal@hic-india.com; belts@universaldelhi.org

**Website :** <http://www.rubber-steel-industrial-products.com>

**Key personnel :** Mr. Anil Gupta, President



## Motor-Generator Drive Flexible Tyre Couplings Technical Specifications



### Flexible Shaft Coupling Dimension Details

Flex shaft coupling size	Coupling max. bore mm (6)	Max speed RPM	Rating		Couplings approx. dimension (mm)				
			Torque motor Kg. M.	H.P./100 RPM	Tyre O.D. (1)	Coupling length (2)	Hub dia (3)	Flange length (4)	Gap bet. two flanges (5)
34-PH	10	7000	Nominal	Nominal	34	34	14	16	6
40-PH	12	7000	-do-	-do-	40	40	17	19	8
46-PH	15	6500	0.87	0.12	46	40	22	19	8
56-PH	18	6000	1.08	0.15	56	48	26	22	11
66-PH	25	6000	1.52	2.21	66	54	36	25	11
76-PH	27	6000	1.81	0.25	76	66	39	30	14
86-PH	34	6000	2.90	0.40	86	76	49	35	14
96-PH	36	5500	3.62	0.50	96	76	51	35	16
106-PH	38	5500	4.35	0.60	106	76	54	35	18
116-PH	42	5500	5.43	0.75	116	88	60	40	22
126-PH	48	5500	9.00	1.25	126	88	68	40	22
140-PH	50	5500	12.70	1.75	140	100	72	46	26
160-PH	57	5000	16.40	2.25	160	108	82	50	28
178-PH	60	4500	22.0	3.00	178	128	100	60	32
190-PH	65	4000	29.0	4.00	190	146	105	70	30
218-PH	75	3500	43.5	6.00	218	160	124	75	36
250-PH	80	3000	62.0	8.50	250	192	145	90	40
272-PH	100	2750	80.0	11.00	272	205	163	90	55
292-PH	105	2600	109	15.00	292	228	168	105	47
316L-PH	90	2500	174	24.00	316	195	150	90	47
316H-PH	115	2500	174	24.00	316	245	190	115	47
342L-PH	90	2250	232	32.00	342	195	150	90	53
342H-PH	120	2250	232	32.00	342	255	198	120	53
390L-PH	100	2000	290	40.00	390	218	165	100	57
390H-PH	140	2000	290	40.00	390	298	230	140	57
450L-PH	130	1600	508	70.00	450	270	216	125	60
50H-PH	175	1600	508	70.00	450	360	286	170	60
520L-PH	150	1400	726	100	520	294	250	135	62
520H-PH	220	1400	7176	100	520	384	354	180	62
600-PH		1300	1310	180	600				
672-PH		1100	1960	270	672				
725-PH		950	2900	400	725				
812-PH		850	4356	600	812				
1000-PH		750	6534	900	1000				
1100-PH		650	8712	1200	1100				
1175-PH		550	10890	1500	1175				
1250-PH		500	14520	2000	1250				



#### Contact For Quote:

HIC INTERNATIONAL CO -Motors Drive Tyre Coupling Div

D-136, Shankar Road, New Delhi - 110060, India

**Phone:** 91-11-6547 2400, 2874 5120

**Fax:** 91-11-2874 2791

**E-mail :** universal@hic-india.com; belts@universaldelhi.org

**Website :** <http://www.rubber-steel-industrial-products.com>

**Key personnel :** Mr. Anil Gupta, President



## Motor-Generator Drive Flexible Tyre Couplings Technical Specifications



### Coupling Sectional View (PH-SERIES)

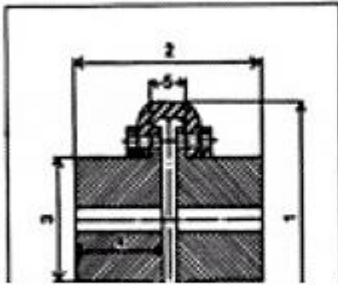

Up to Size 520 PH

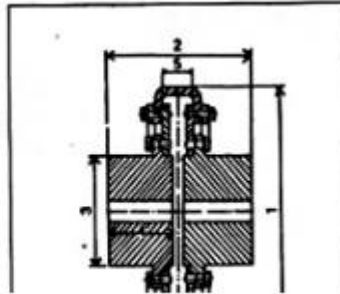

For Sizes 600 PH to 1250 PH

### PH Tyre Coupling

### Coupling Tire Information To Be Supplied With Enquiry or Order

1. Motor HP rating i.e. 15 or 60 Horse Power & so on.
2. RPM at which coupling is to run i.e. 650 or 1400 & so on.
3. Bore size in mm i.e. 9 or 15 mm & so on.
4. Coupling Type i.e. TC series or F series or PH series.
5. Machine type.
6. Quantity in nos.

Disclaimer: Information's, written and verbal are provided by HIC, relative to its products which it determines to be reliable & no liabilities of whatsoever nature in regards to its uses. The purchaser of UNIVERSAL brand industrial products should determine for itself the suitability of such products.



#### Contact For Quote:

HIC INTERNATIONAL CO -Motors Drive Tyre Coupling Div

D-136, Shankar Road, New Delhi - 110060, India

**Phone:** 91-11-6547 2400, 2874 5120

**Fax:** 91-11-2874 2791

**E-mail :** universal@hic-india.com; belts@universaldelhi.org

**Website :** <http://www.rubber-steel-industrial-products.com>

**Key personnel :** Mr. Anil Gupta, President